

**READ AND UNDERSTAND COMPLETE INSTRUCTIONS BEFORE USING:**

1. Secure the endotracheal tube per instructions or institution procedure. Gently pull the pilot tube in a straight line toward the end of the endotracheal tube.

2. Starting with the Bite Proof Bite Block at a slight angle, snap the back of the Bite Proof Bite Block onto the endotracheal tube. Keeping the Bite Proof Bite Block at a slight angle, slide it onto the tube. Make SURE the pilot balloon is between the Bite Proof Bite Block and the endotracheal tube (Figure B).

3. Keeping the pilot balloon tube taut, gently slide the Bite Proof Bite Block down the tube until the wing is at lower lip.

4. Slowly rotate the Bite Proof Bite Block until the wing is positioned laterally to the tube (Figure C). Peel backing from the wing and secure it to the cheek. Keeping the pilot balloon taut, position the Bite Block to the proper depth (Figure D).

5. Secure the tab of the Bite Proof Bite Block to the endotracheal tube with adhesive tape (Figure E). If using the B&B tube holders, secure tube according to direction and overlap tab with tape. Note: Tab must be securely taped to the endotracheal tube (Figure F).

6. Periodically inspect the Bite Proof Bite Block for proper positioning and function of the device. Replace immediately for loss of adhesion to the face or the E.T. Tube.

7. Bite Proof Bite Block should be changed every two days for hygienic purposes.

An instructional application video can be found at [www.bandb-medical.com/content/11040\\_vid.htm](http://www.bandb-medical.com/content/11040_vid.htm)

**CAUTION: NEVER use Benzoin or other adhesive enhancing products in conjunction with this product. Should cuff filling problem occur, gently pull the pilot balloon tube taut to remove any kinks. NEVER remove the wing from the Bite Proof Bite Block.**

**CAUTION: Single Patient Use Only • Disposable • Not Sterile • DO NOT REUSE • DO NOT REPROCESS •**

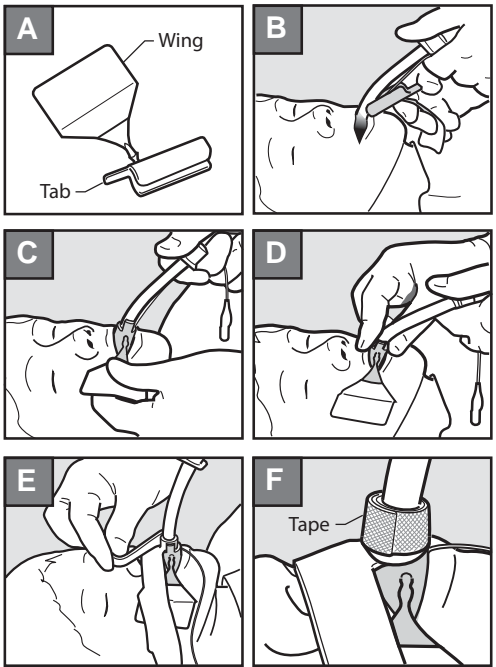

**B&B**  
MEDICAL TECHNOLOGIES

**Bite Proof Bite Block™**  
Latex Free Endotracheal Tube Bite Block  
For Tube Sizes 6 mm to 9.5mm

REF # 11040



Contents: 1 UNIT

— Not Sterile —

Read and Understand

Complete Instructions Before Using.  
Disposable - Single Patient Use Only.

**Caution: Federal (USA) Law restricts this device to sale by or on order of a physician.**



Manufactured for:  
B&B MEDICAL TECHNOLOGIES  
by:  
INTEGRA BIOTECHNICAL, LLC  
2755 Dos Aarons Way, Suite B  
Vista, CA 92081 U.S.A.  
Phone +1.760.929.9972  
Fax +1.760.929.9953  
[www.BandB-Medical.com](http://www.BandB-Medical.com)

**LOT #**

Form: S104U Rev 1.0  
Made in USA

© 2010 All Rights Reserved  
Assembled in Mexico